

NEW

**ANALOG AND  
DIGITAL**  
SYSTEM AVAILABLE

COMMON INPUT  
FOR EXTERNAL  
**RESET**



**FULLY  
VACUUM  
COMPATIBLE**

**3, 4, 5 OR 7  
CHANNELS**  
WITH H7 TO H50

**FINGER LENGTHS  
200 mm TO 600 mm**

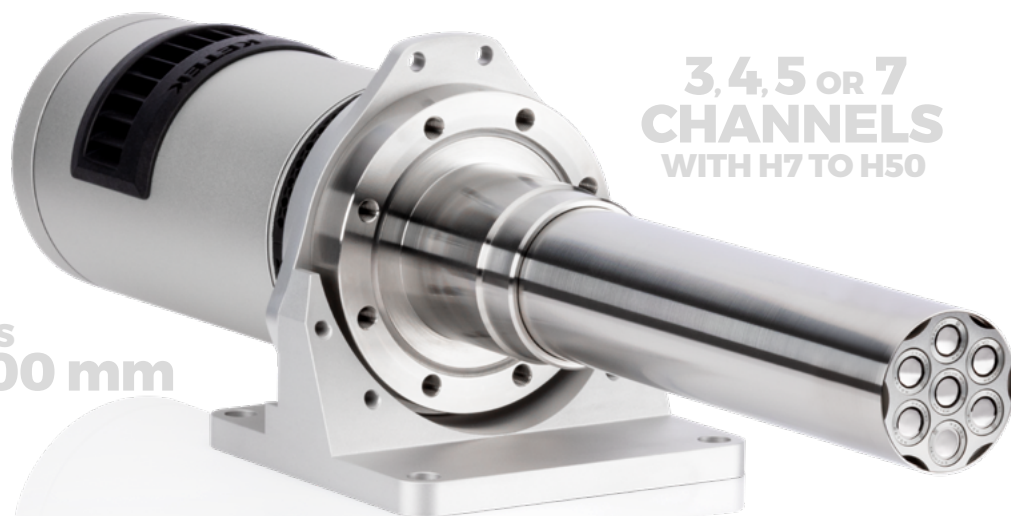

**ARRAY  
3.0**

## KETEK ARRAY 3.0 MULTI-CHANNEL SDD ARRAY

Complete XRF multi-channel system with 3 to 7 Silicon Drift Detector channels with integrated cooling and power supply unit. Each channel consists of a vacuum-tight SDD module, ultra-low noise preamplifier and a digital pulse processor board (analog version available).



- 3, 4, 5 or 7 channels configurable
- No additional chiller, vacuum pump or ion getter pump necessary; system can be switched off without loss of vacuum
- Air cooled system, no heat pipe used; system can be mounted in any direction

- KETEK VITUS H7 to H50 SDD modules (vacuum encapsulated)
- Two different graphene window types available for high energies (CH) and low energies (CL)
- Up to 350 mm<sup>2</sup> active collimated area
- Guaranteed: FWHM  $\leq 133$  eV @ 1  $\mu$ s peaking time for Mn K $_{\alpha}$  line
- Optimized for high input count rates up to 1 Mcps per channel and short peaking times down to 0.1  $\mu$ s
- X-ray detection energy range from 0.1 keV to > 30 keV
- Standard finger lengths: 200, 300, 400, 500 or 600 mm (customized length available)
- Fully UH-Vacuum compatible, vacuum flange CF-63 (customized flange available)

Spectrum of an ARRAY 3.0 with VITUS SDD H50s showing an excellent performance in a multi-channel measurement.  
**No crosstalk between the channels is observed.**

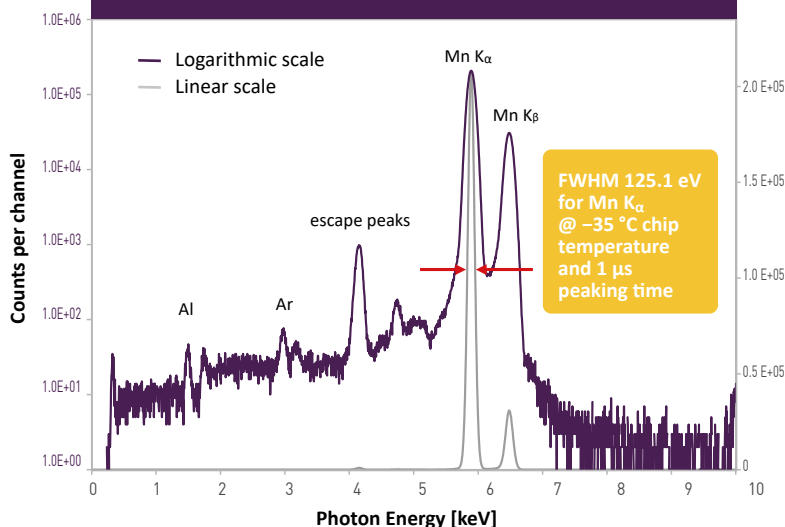

**ISO 9001**  
Certified  
Quality Management System  
[www.tuvsud.com/ms-cert](http://www.tuvsud.com/ms-cert)



# ARRAY 3.0



- Analog and digital version available
- Digital system with integrated USB-Hub (analog output always accessible)
- One common input for external RESET
- INHIBIT output for each channel available
- Status LED for each channel and for system status

FRONT VIEW

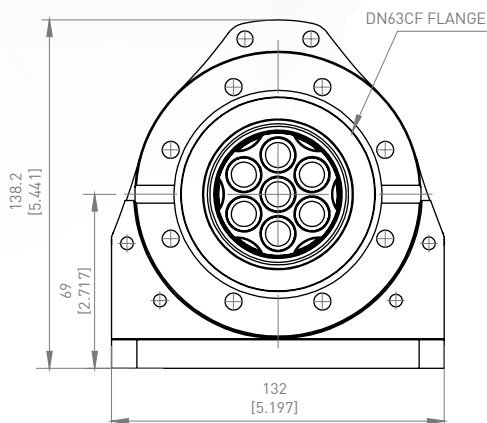

BACK VIEW

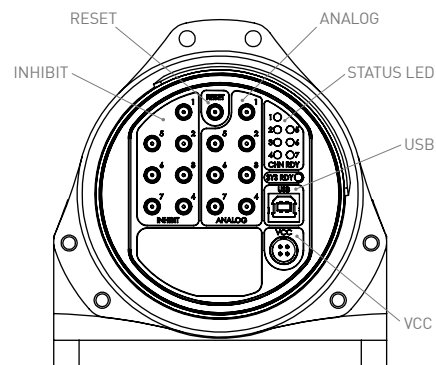

SIDE VIEW

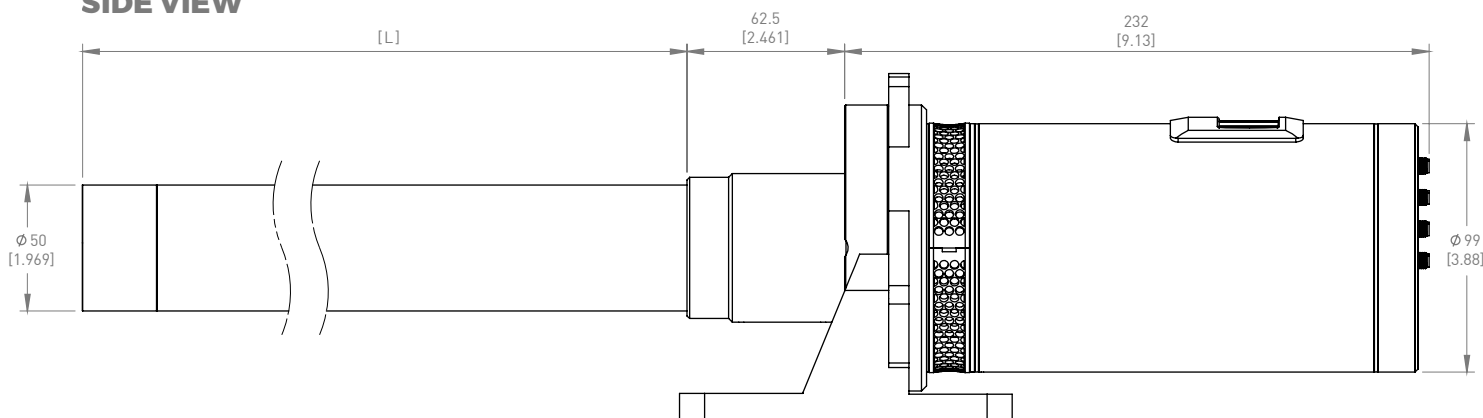

[ L ] STANDARD LENGTHS 200 / 300 / 400 / 500 / 600 mm  
CUSTOMIZED LENGTH ON REQUEST

## SNOUT WITH DIFFERENT CONFIGURATION EXAMPLES

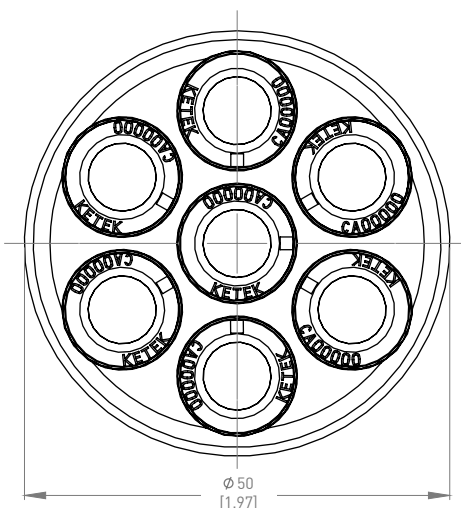
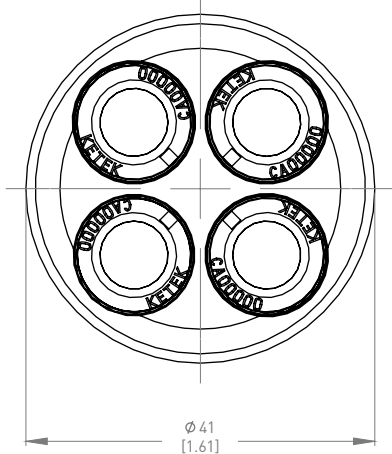
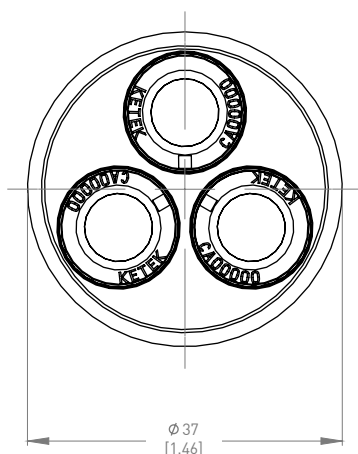

OUTER DIAMETER FOR 5 AND 7 CHANNELS IDENTICAL